



HONEYCOMB

Fully Fitted, Flexible Office Suites, Liverpool City Centre.

Honeycomb Building, Edmund Street, Liverpool L3 9NG

- Desirable Location
- On site Bike & Shower facilities
- Free Meeting Room facilities
incl. complimentary coffee
machine
- 24/7 Access
- Roof Terrace
- Ability to Grow within the building
- Available on an All-Inclusive Basis

2nd Floor - Suite 11a £130 per Workstation

- 28 Workstations
- Flexible Agreement Available
- Fully Inclusive Rent*
- Wi-Fi Ready
- Fitted Kitchen with integrated appliances
- Dedicated Private Office/Meeting Room
- Air Conditioning with exposed services

* Excludes cleaning to the suite

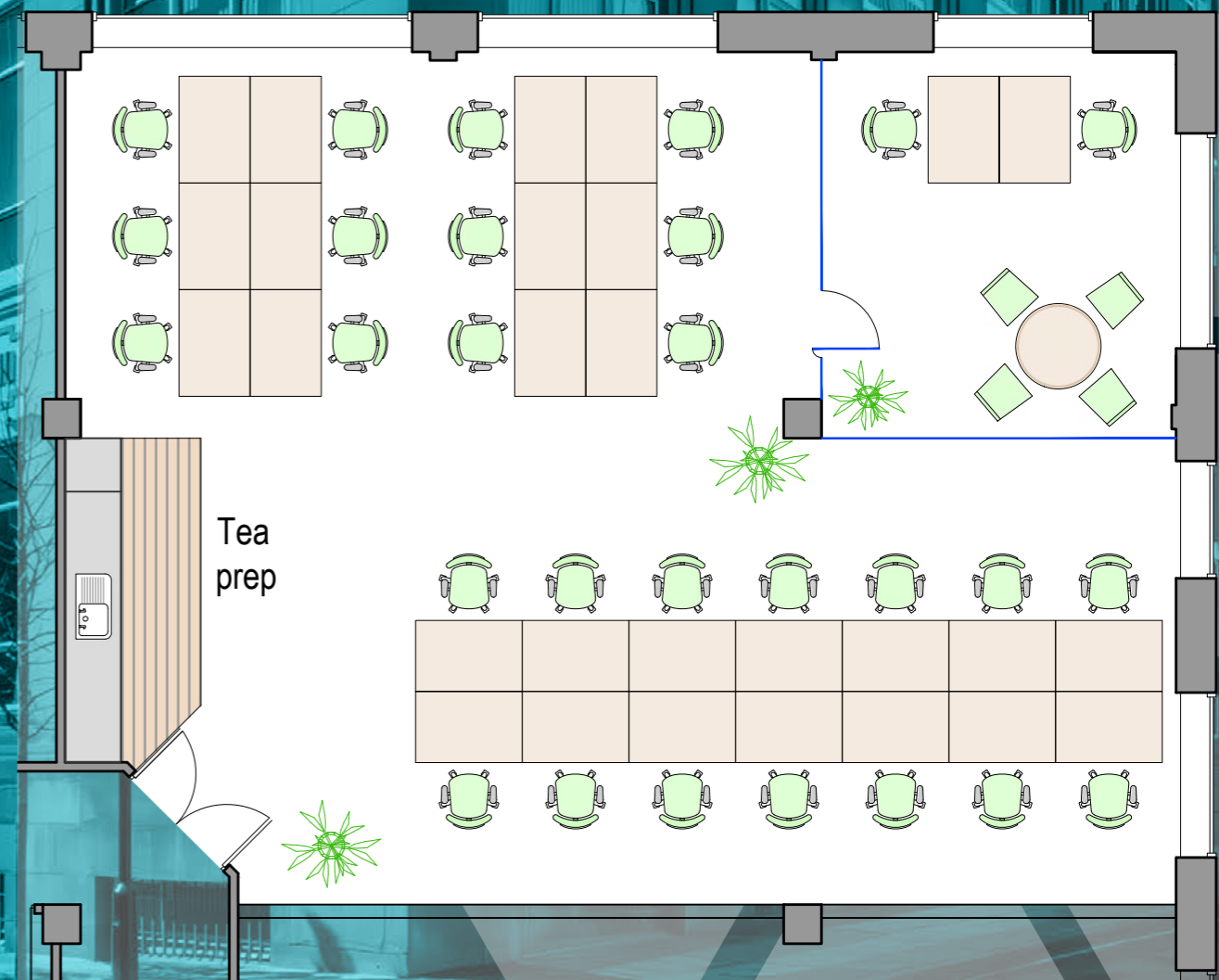

HONEYCOMB

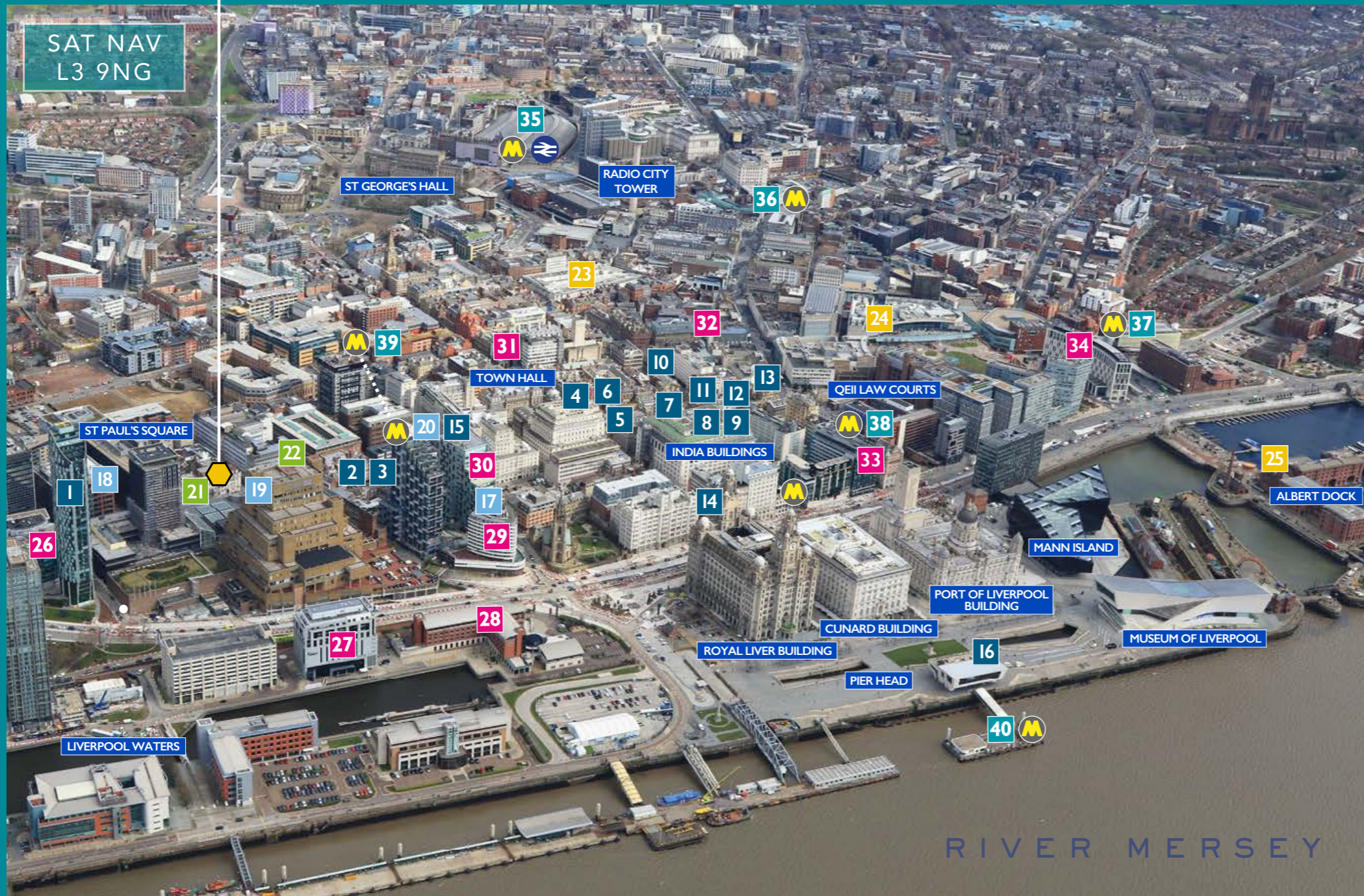

RESTAURANTS & BARS

- 1 Panoramic 34 Restaurant
- 2 Trattoria 51
- 3 City Wine Bar
- 4 Gino D' Acampo
- 5 Mowgli
- 6 Rudy's Neopolitan Pizza
- 7 Viva Brazil
- 8 Restaurant Bar & Grill
- 9 The Alchemist
- 10 Piccolino
- 11 San Carlo Restaurant
- 12 Bacaro
- 13 Pret A Manger
- 14 Oh Me Oh My
- 15 El Gato Negro
- 16 Matou Pan Asian Restaurant

COFFEE SHOPS

- 17 Bean
- 18 Costa Coffee
- 19 Starbucks
- 20 Costa Coffee

CONVENIENCE STORES

- 21 Sainsbury's
- 22 Tesco Express

RETAIL

- 23 Metquarter
- 24 Liverpool ONE
- 25 Albert Dock

HOTELS

- 26 Radisson Blu Hotel
- 27 Malmaison
- 28 Crowne Plaza
- 29 Mercure Atlantic Tower Hotel
- 30 Hotel Indigo
- 31 Aloft Liverpool
- 32 Hard Days Night Hotel
- 33 30 James Street
- 34 Liverpool Hilton

PUBLIC TRANSPORT

- 35 Lime Street Main Line Station
- 36 Central Station
- 37 LiverpoolONE Bus Station
- 38 James Street Station
- 39 Moorfields Station
- 40 Mersey Ferry Terminal

DETAILED INFORMATION IS AVAILABLE FROM THE JOINT SOLE AGENTS



mark@worthingtonowen.com

brianricketts@hwandp.co.uk

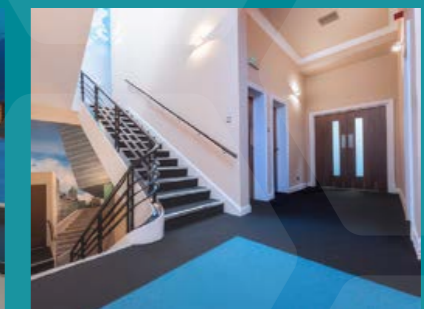

MISREPRESENTATION ACT

The joint agents for themselves and the vendors or lessors of this property whose agents they are give notice that (1) The particulars do not constitute any part of an offer or contract, (2) All statements contained in these particulars as to this property are made without responsibility on the parts of the joint agents or vendors or lessors, (3) All descriptions, dimensions and other particulars are given in good faith and are believed to be correct, but any intending purchaser or tenant should not rely on them as statements or representations of fact and must satisfy themselves by way of investigation or otherwise as to the correctness of each of them, (4) No person in the employment of the joint agents has any authority to make or give any representation or warranty whatsoever in relation to this property, (5) Unless otherwise stated prices and rents are quoted exclusive of VAT.